

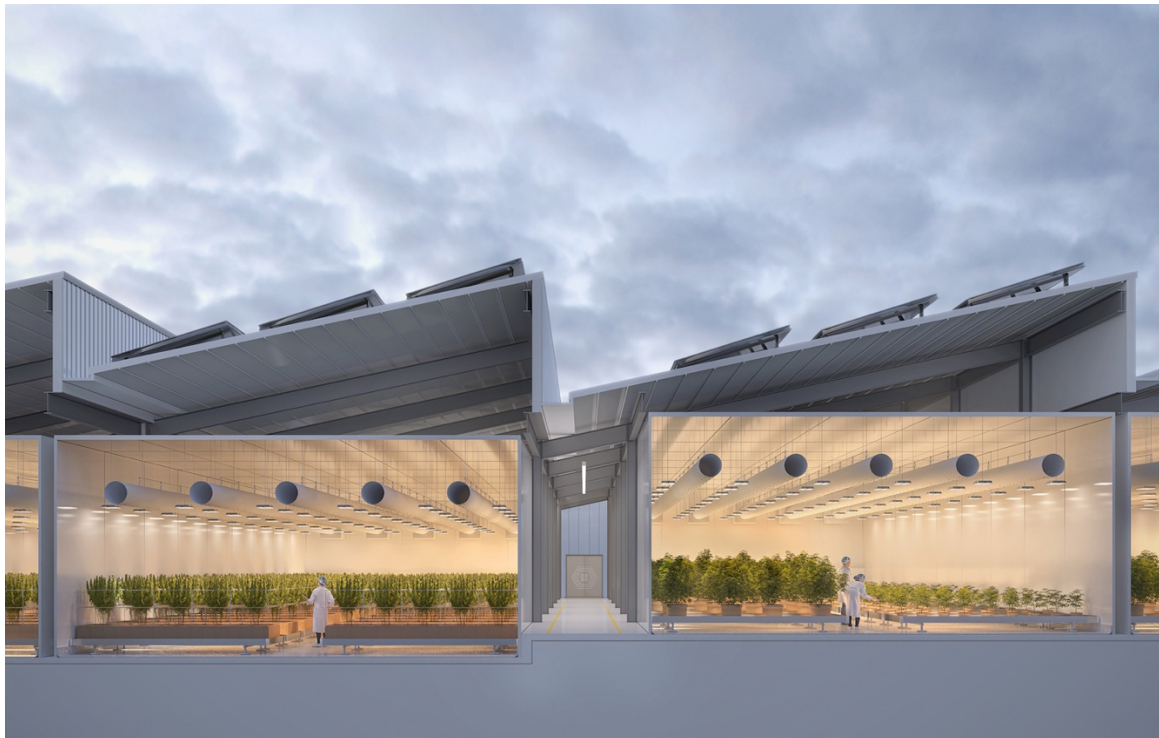

FOR IMMEDIATE RELEASE

8th September 2023

MAILEN DESIGN and GLO SUBMIT PLANNING FOR FIRST PURPOSE BUILT CANNABIS FARM ON ISLE OF MAN



London and Oxfordshire based architects, [Mailen Design](#), have submitted planning for the first indoor, purpose built cannabis facility, on the Isle of Man.

“The GrowLab” will be one of the first facilities on the British Isles, producing cannabis for medicinal use. The purpose built fully indoor cultivation and processing facility will allow the growing and harvesting of cannabis plants alongside processing facilities for conversion into medicine and distribution to patients. Funding for the community owned farm has been raised through [Seedrs](#), with over £6m from 2200+ investors.

Working closely with the client, [GrowLab Organics](#) (GLO), the design team generated layouts and building form based on an iterative approach of testing functional process and the flow of activity required for horticulture and cultivation. The building shape and form is a combined result of the design development of both building and functional process. Careful consideration of specialist building services was crucial through a design where enclosed growing rooms needed to re-create daylight in a highly controlled environment. The design was



developed in 3D from the outset using BIM software with the extensive use of virtual reality assisting the clients' consideration of key spaces.

Ben Mailen, Director at Mailen Design, said:

"The design brief was to create a facility that achieves two main objectives. Firstly, it needs to be a highly functional space that efficiently caters to the technical demands of growing natural products, particularly cannabis. Secondly, it must present an open and inviting front face for a global headquarters building, with the intention of reshaping people's perception of cannabis cultivation and use. By doing so, it aims to challenge any negative stigmas associated with the industry and foster a more positive and progressive outlook."

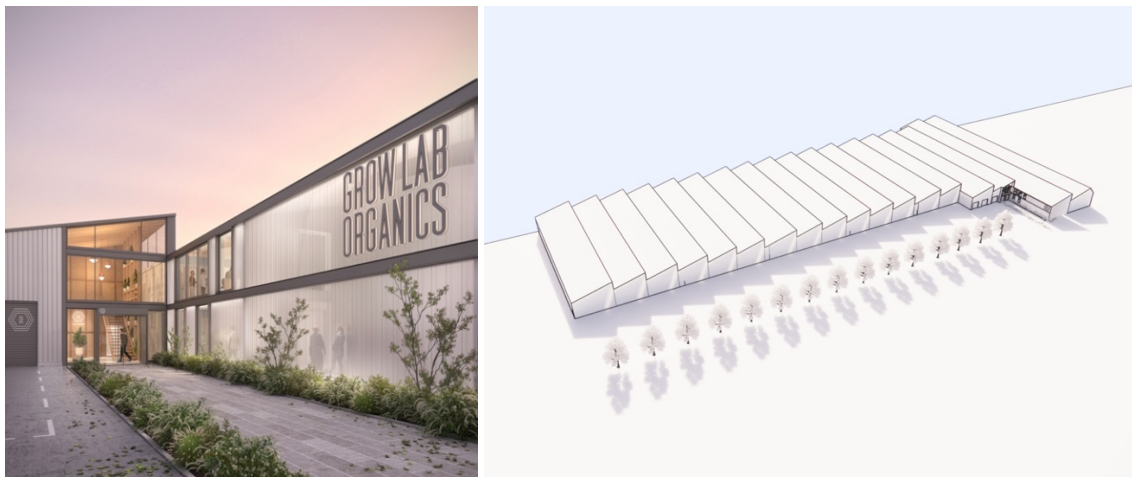

Alex Fray, GLO Chief Executive, said:

"The emerging cannabis sector is potentially the most exciting global development of this generation and has the capability to transform the quality of life for millions of people. GLO's mission is to help people live better through the power of cannabis, whilst reducing the need for people to source cannabis from illicit sources for medicinal purposes."

Tim Crookall, Minister Isle of Man Enterprise, said:

"The approval of a licence to produce medicinal cannabis products on the Isle of Man represents the dawn of a new economic sector. It will drive high-value economic diversification and provide new jobs and training opportunities as well as encourage inward investment".

Earlier this month, a public consultation was held on the Isle of Man where members of the public were invited to tour the proposed GrowLab facility through VR. Construction is expected to start in Autumn 2023.

END_



Notes to editors

Mailen Design is a London and Oxfordshire based architecture studio founded in 2011. Their work is rooted in a passionate care for well crafted, uplifting buildings and spaces. They have been the recipient of numerous design awards and in 2019 they were shortlisted as BD Young Architect of the Year. www.mailendesign.com

The client, **GrowLab Organics** (GLO) has been offered a conditional licence to cultivate, extract, manufacture, import and export the drug.

Over a million people are using cannabis in the UK daily but do so with the fear of criminalisation. Legally there is limited choice and the accessibility varies as wildly as the quality. Patients will be able to access the quality of medicine that they deserve.

For further information, please contact

Hanan Kandili

The Double Unit Publicists

hanankandili@thedoubleunit.com

+44 (0)20 7099 7829

+44 (0)7827 963 929